

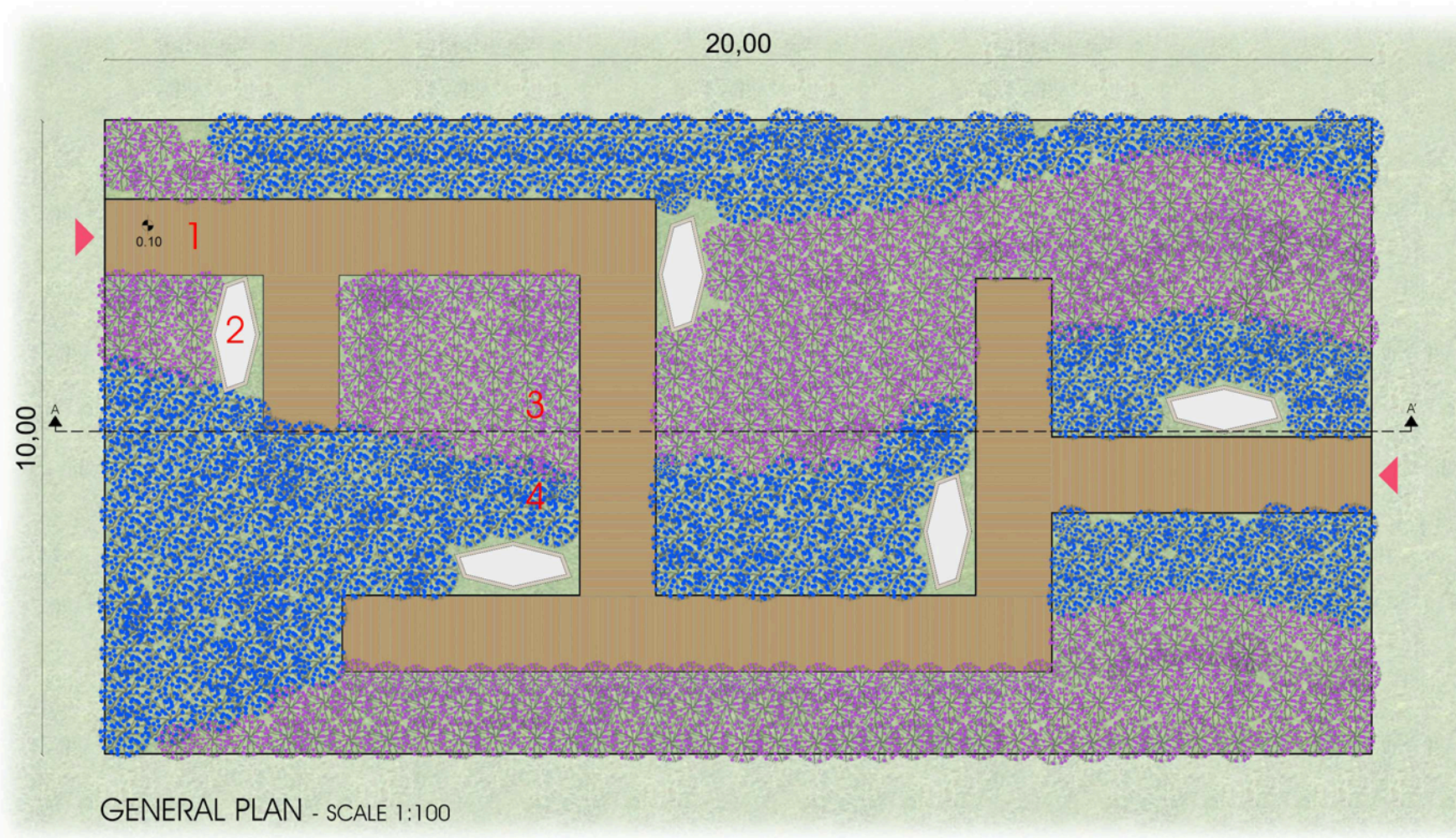

SECTION A - A' - SCALE 1:100



GENERAL PLAN - SCALE 1:100



1 - "BOAT" BENCH



3 - LAVANDULA

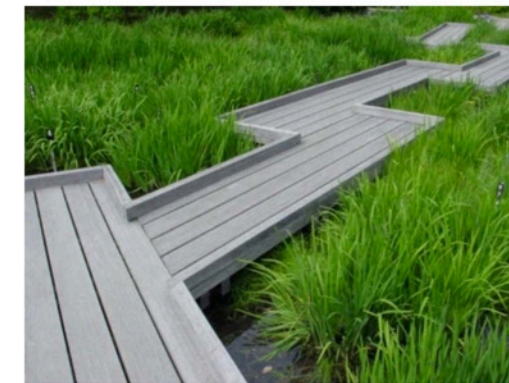

2 - WOODEN PATH

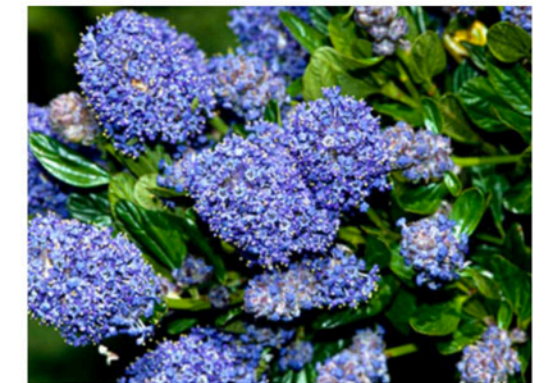

4 - CEANOTHUS

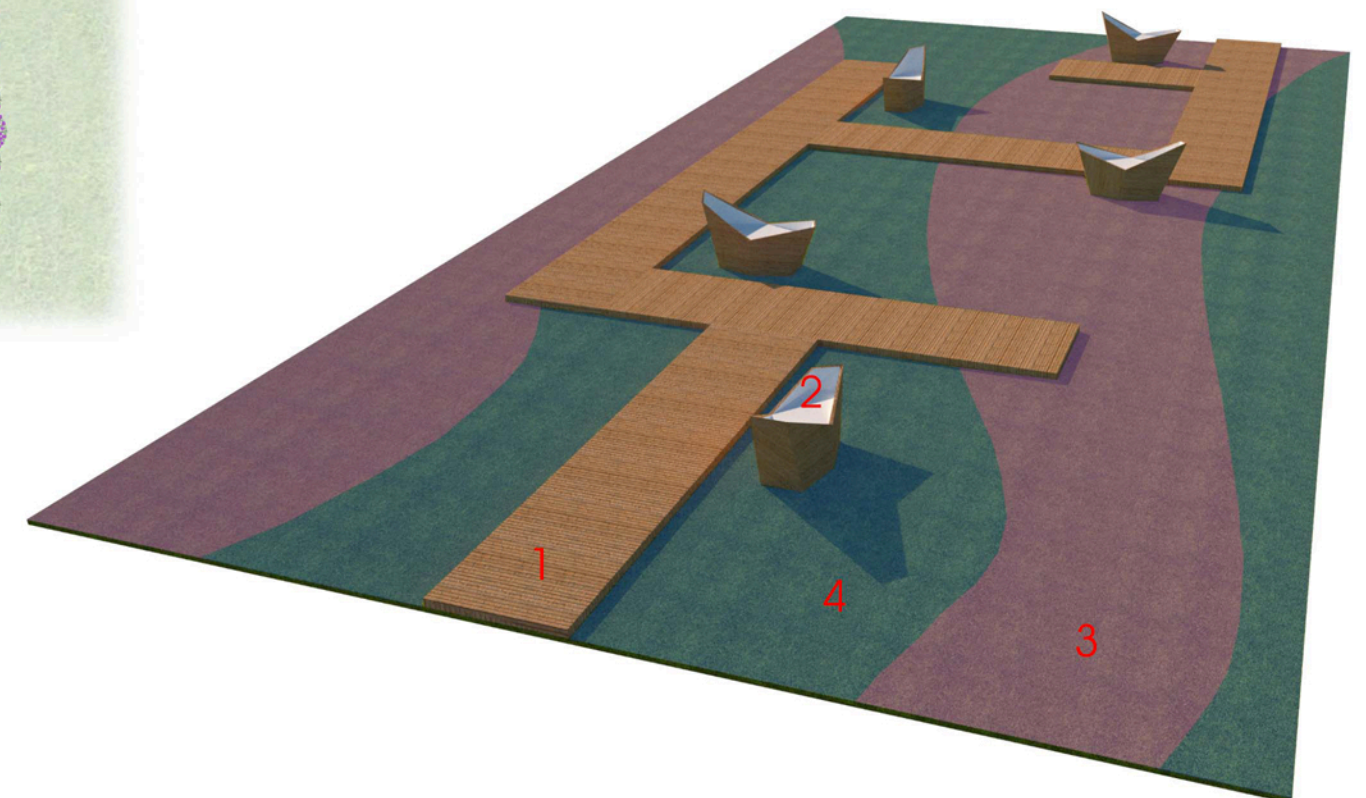

GENERAL VIEW

The game is an essential aspect of life through which the child develops physical, moral and social integration skills. The game creates the right state of mind to solve problems and complications that hinder us during our lives. The dimension of the game is here embodied in an imaginary sea, a place of peaceful carefree, which inspires unexplored sensations and youthful memories in us. Through play and sight, we can reconnect with our inner self, rediscover our true essence and feel part of a whole.

The project recreates a port, a symbol of travel, exploration, arrival and destination, all elements that stimulate us to reflect. Children, through the game, will be able to imagine new lands to be conquered or ships to be attacked, being a lookout on the board of the vessel-shaped seats; the same ones that will welcome their parents, who, lying down, will let themselves be inebriated by the essence of Lavandula and Ceanothus that with their nuances will simulate the marine ripples.

